

Bench drilling tools

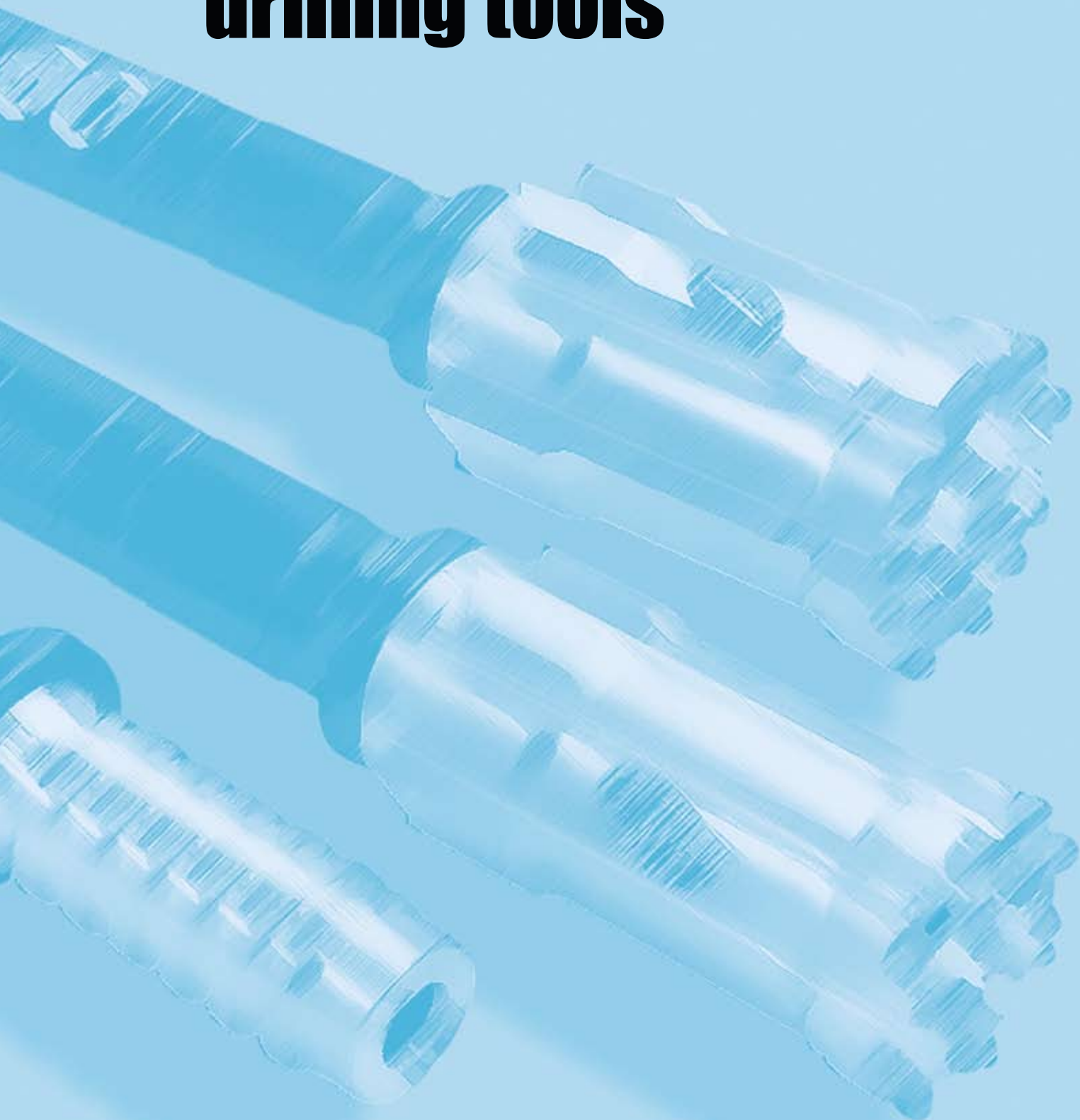

SANDVIK

Bench drilling

S

Page

Bench drilling tools, R32 21

T

Bench drilling tools, T35 23

Bench drilling tools, T38 24

N

Bench drilling tools, R38 27

Bench drilling tools, T45 29

E

Bench drilling tools, T51 32

Bench drilling tools, Sandvik GT 60 34

T

N

O

G

Bench drilling

R32 (1 1/4")

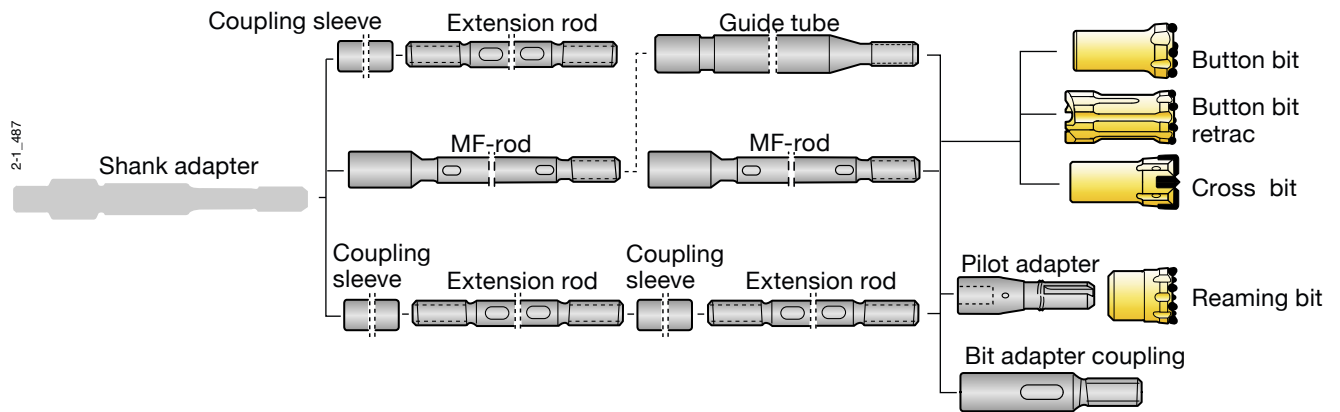

Flushinghole, mm		Buttons, mm			Dimensions D mm in	Bit classi- fication	Part No.
Front No	Gauge No Size	Front No	Gauge No Size	Angle			

Button bit



3x6	—	3x9	6x10	35°	51 2"	HMCVA	7733-5351-S45
3x6	—	3x9	6x10	35°	51 2"	MSCAN	7733-5351-R45
3x6	—	3x10	6x11	35°	57 2 1/4"	HMCVA	7733-5357C-S45

Button bit

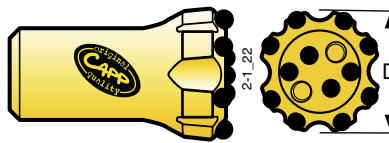

2x9.0	—	4x10	8x10	30°	64 2 1/2"	HMCVA	7733-2664-S45
-------	---	------	------	-----	-----------	-------	---------------

Button bit

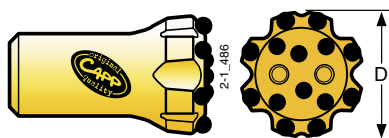

1) 2x9	—	6x10	8x11	35°	76 3"	HMCVA	7733-2676-S45
--------	---	------	------	-----	-------	-------	---------------

1) For very short holes only.

Button bit, Retrac



3x6	—	3x10	6x11	30°	51 2"	HMCVFA	7733-7851-S45
3x6	—	3x10	6x11	30°	51 2"	MSCFAN	7733-7851-R55
2x9	—	4x10	8x10	30°	64 2 1/2"	HMCVFA	7733-7864-S45

Cross bit



1x5	2x7.5	—	—	—	51 2"	—	7733-1451-42
1x5	2x7.5	—	—	—	57 2 1/4"	—	7733-1057-42
1x5	2x7.5	—	—	—	64 2 1/2"	—	7733-1064-42

Guide bit



3x6	—	3x8	6x10	40°	51 2"	—	7733-8251-R45
3x6	—	4x8	6x10	40°	57 2 1/4"	—	7733-8257-R45

Bench drilling

R32 (1 1/4")

Bit dia, mm	Dimensions			D		Part No.
	L mm	ft	in	mm	in	

Guide Tube

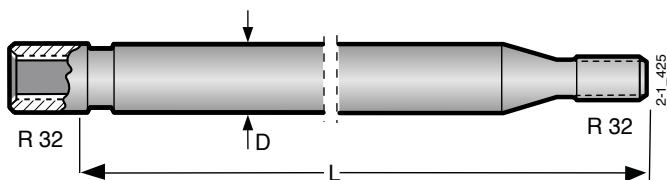

51-64	1830	6'	-	46	1 3/4"	7953-4618-20
51-64	3050	10'	-	46	1 3/4"	7953-4631-20

Female end OD 46 mm.

MF-rod, R32 - Round 32 - R32

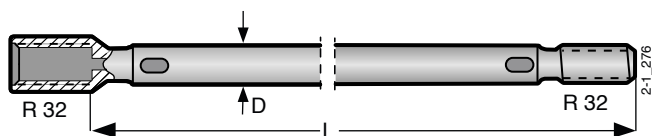

Flushing hole Ø 9.2 mm. Wrench flat 25.4 mm.
Female end OD 45 mm.

915	3'	-	32	1 1/4"	7853-5109-20
1220	4'	-	32	1 1/4"	7853-5112-20
1525	5'	-	32	1 1/4"	7853-5115-20
1830	6'	-	32	1 1/4"	7853-5118-20
3050	10'	-	32	1 1/4"	7853-5131-20
3660	12'	-	32	1 1/4"	7853-5137-20
4265	14'	-	32	1 1/4"	7853-5143-20

Extension rod, R32 - Round 32 - R32

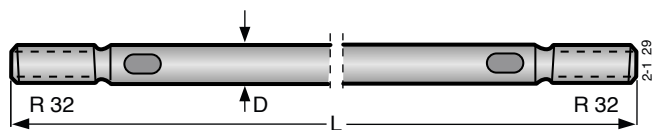

Flushing hole Ø 11.7 mm. Wrench flat 25.4 mm.

915	3'	-	32	1 1/4"	7853-3309-20
1220	4'	-	32	1 1/4"	7853-3312-20
1830	6'	-	32	1 1/4"	7853-3318-20
2435	8'	-	32	1 1/4"	7853-3324-30
3050	10'	-	32	1 1/4"	7853-3331-30
3660	12'	-	32	1 1/4"	7853-3337-30

Coupling sleeve R32

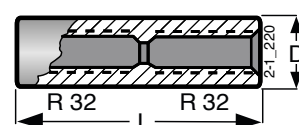

150	-	5 29/32"	44	1 47/64"	7993-3644
-----	---	----------	----	----------	-----------

Bit adapter coupling, R32 -Thread

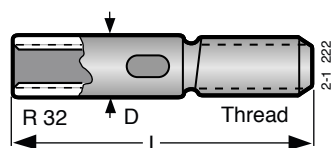

Wrench flat 38 mm.

Thread	L mm	ft	in	D mm	in	Part No.
R38	225	-	8 55/64"	45	1 49/64"	7833-4301
T38	225	-	8 55/64"	45	1 49/64"	7833-4401

Reduction coupling, R32 - Thread

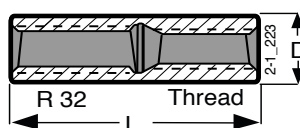

Thread	L mm	ft	in	D mm	in	Part No.
R25	160	-	6 1/4"	43	1 11/16"	7993-2443
R28	165	-	6 1/4"	44	1 47/64"	7993-0444
R38	170	-	6 11/16"	55	2 5/32"	7994-3455
T38	195	-	7 11/16"	55	2 5/32"	7314-3555

Shank adapter



See page 87

Bench drilling

T35(1 3/8") bit thread

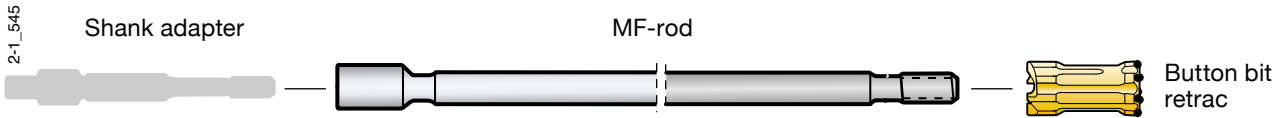

Flushinghole, mm		Buttons, mm			Dimensions		Bit classification	Part No.
Front	Gauge	Front	Gauge	Angle	D			
No Size	No Size	No Size	No Size		mm	in		

Button bit, Retrac T35

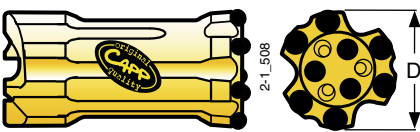

3x6	—	—	9x11	25°	54	2 1/5"	MSCFAN	7517-7854-R55
3x6	—	—	9x11	30°	57	2 1/4"	MSCFAN	7517-7857-R55

Dimensions		D		Part No.
L		mm	in	
mm	ft			

MF-rod, T35 - Round 39 - T35

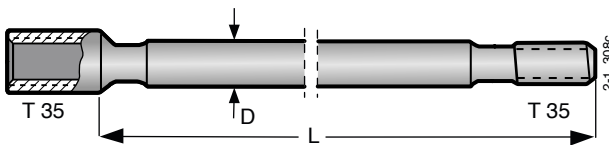

1830	6'	39	1 1/2"	7327-4718-20
3050	10'	39	1 1/2"	7327-4731-20
3660	12'	39	1 1/2"	7327-4737-20

Female end OD 48,2 mm.
Flushing hole Ø 14,5 mm.

Shank adapter



See page 87

Bench drilling

T38 (1 1/2")

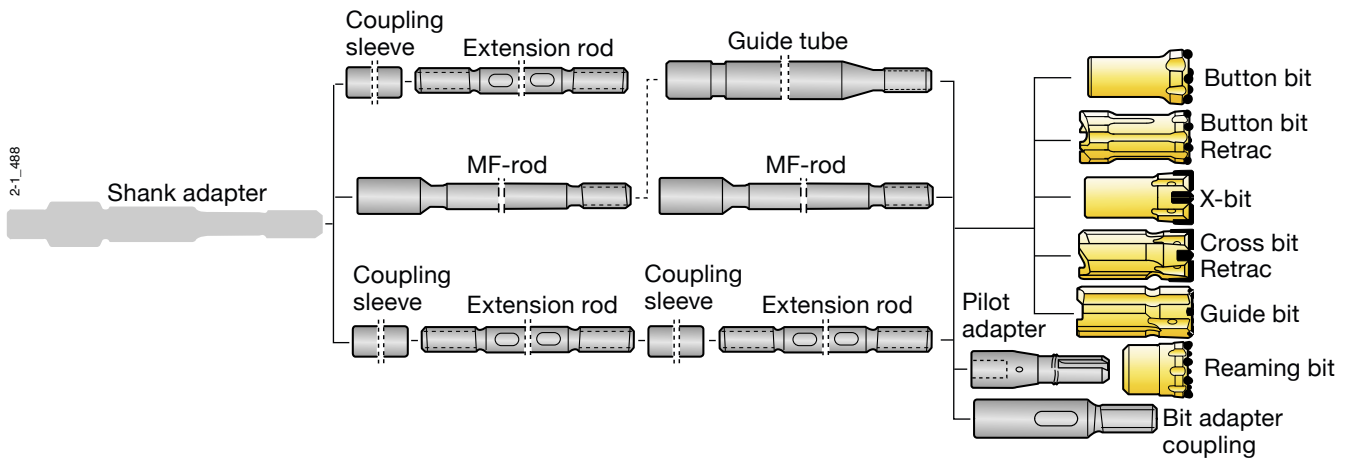

Flushinghole, mm		Buttons, mm		Angle	Dimensions		Bit classification	Part No.
Front No	Gauge No	Front No	Gauge No		D mm	in		

Button bit

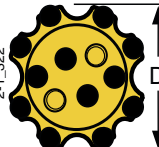
		2x11	—	4x10	8x10	35°	64	2 1/2"	MSCAN	7514-2664-R55
		2x11	—	4x10	8x10	30°	64	2 1/2"	HMCVA	7514-2664-S45
		2x11	—	6x10	8x10	35°	70	3 3/4"	HMCVA	7514-2670-S45
		3x11	—	6x10	8x11	40°	76	3"	MSCAN	7514-2676-R55
		2x11	—	6x10	8x10	35°	76	3"	HMCVA	7514-2676-S45
		3x10	—	6x10	9x11	35°	89	3 1/2"	HMCVA	7514-2689-S45

Button bit

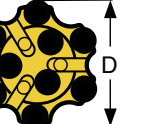
		3x7	—	3x11	6x12	30°	64	2 1/2"	HMCVA	7514-3864-S45
		3x7	—	3x11	6x12	30°	64	2 1/2"	HMCVA	7514-3864-S65

Button bit

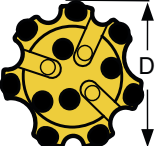
		3x9	—	4x11	7x12	35°	76	3"	HMCVA	7514-3876-S45
		3x9	—	4x11	7x12	35°	76	3"	HMCV	7514-3876-S65

Button bit, Drop Center

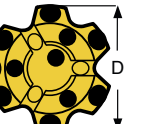
		3x8.0	—	4x9	6x10	35°	64	2 1/2"	HMCVA	7514-5964-S45
		3x8.0	—	4x9	6x10	40°	64	2 1/2"	MSCAN	7514-5964-R55
		4x7.0	—	6x10	8x11	30°	76	3"	HMCVA	7514-5976-S45
		4x8.0	—	6x10	8x11	35°	76	3"	MSCAN	7514-5976-R55

Button bit, Retrac

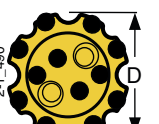
		2x11	—	4x10	8x10	30°	64	2 1/2"	HMCFA	7514-7864-S45
		2x11	—	4x10	8x10	35°	64	2 1/2"	MSCFAN	7514-7864-R55

Bench drilling

T38 (1 1/2")

	Flushinghole, mm		Buttons, mm			Dimensions		Bit classification	Part No.
	Front	Gauge	Front	Gauge	Angle	D			
	No	Size	No	Size		mm	in		
Button bit, Retrac									
	2x11	—	6x10	8x10	35°	70	2 3/4"	HMCFVA	7514-7870-S45
	2x11	—	6x10	8x11	35°	76	3"	HMCFVA	7514-7876-S45
	2x11	—	6x10	8x11	40°	76	3"	MSCFAN	7514-7876-R55
Button bit, Retrac, Drop Center									
	3x8	—	4x9	6x10	35°	64	2 1/2"	HMCFVA	7514-7964-S45
	3x8	—	4x9	6x10	40°	64	2 1/2"	MSCFAN	7514-7964-R55
	4x7	—	6x10	8x11	30°	76	3"	HMCFVA	7514-7976-S45
	4x8	—	6x10	8x11	35°	76	3"	MSCFAN	7514-7976-R55
X-bit									
	1x7.5	2x7.5	—	—	—	64	2 1/2"	—	7514-4064-11
	1x7.5	2x7.5	—	—	—	76	3"	—	7514-4076A-11
Cross bit, Retrac									
	1x7.5	2x7.5	—	—	—	64	2 1/2"	—	7514-8064-11
Guide bit									
	3x6	—	4x9	6x11	35°	64	2 1/2"	—	7514-8264-R45
Guide tube									
	Bit dia. mm		Dimensions		D		Part No.		
			L	mm	ft	in	mm	in	
	64-76		1830	6'	—	56	2 13/64"	7955-5618-20	
	64-76		3100	10'	—	56	2 13/64"	7955-5631-20	
64-76		3700	12'	—	56	2 13/64"	7955-5637-20		
Female end OD 56 mm.									
MF-rod, T38 - Round 39 - T38									
	1220		4'	—	39	1 1/2"	7324-4712C-20		
	1525		5'	—	39	1 1/2"	7324-4715C-20		
	1830		6'	—	39	1 1/2"	7324-4718C-20		
	3050		10'	—	39	1 1/2"	7324-4731-70		
	3660		12'	—	39	1 1/2"	7324-4737-70		
	4265		14'	—	39	1 1/2"	7324-4743-70		
Flushing hole Ø 14.5 mm. Female end OD 56 mm.									

Bench drilling

T38 (1 1/2")

	Dimensions			D		Part No.
	L			mm	in	
	mm	ft	in			
Extension rod, T38 - Round 39 - T38	1220	4'	—	39	1 1/2"	7324-4312C-20
	1830	6'	—	39	1 1/2"	7324-4318C-20
	3050	10'	—	39	1 1/2"	7324-4331C-30
	3660	12'	—	39	1 1/2"	7324-4337C-30

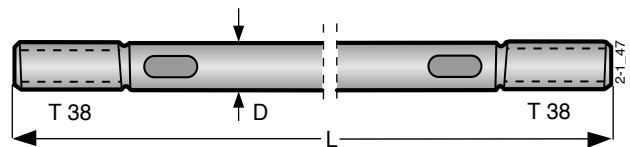

Flushing hole Ø 14.5 mm. Wrench flat 32 mm.

Light extension rod, T38 - Hex 32 - T38

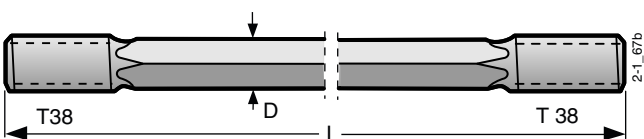

Flushing hole Ø 9.7 mm.

Coupling sleeve

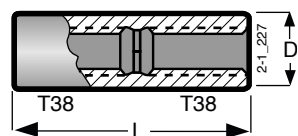

191	—	7 1/2"	55	2 5/32"	7314-3355
-----	---	--------	----	---------	-----------

Bit adapter coupling, T38 - Thread

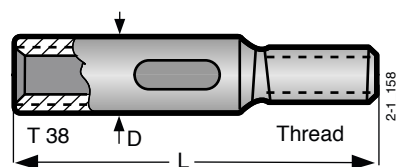

Wrench flat 44.5 mm.

Thread						
R32	270	—	10 41/64"	57	2 1/4"	7334-3301
R38	280	—	11 1/32"	57	2 1/4"	7334-4301
T45	285	—	11 7/32"	57	2 1/4"	7334-5401

Reduction coupling, T38 - Thread

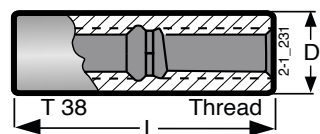

Thread						
R32	195	—	7 11/16"	55	2 5/32"	7314-3555
R38	185	—	7 9/32"	55	2 5/32"	7314-4455
T45	220	—	8 21/32"	61	2 3/8"	7314-6261

Shank adapter



See page 87

Bench drilling

R38 (1 1/2")

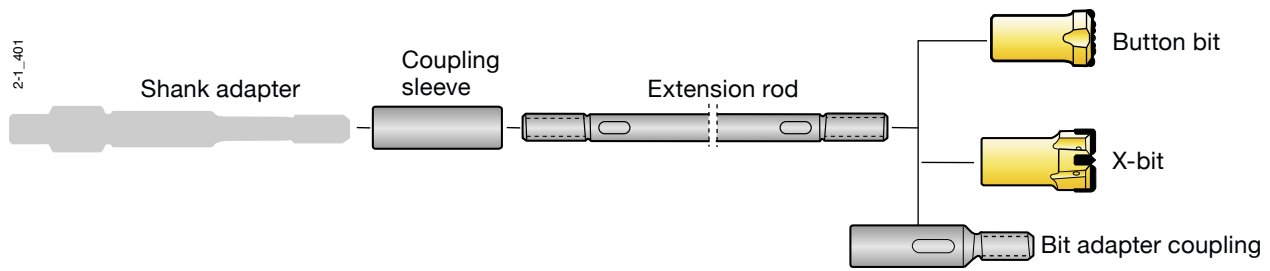

Flushinghole, mm		Buttons, mm		Angle	Dimensions		Bit classification	Part No.
Front	Gauge	Front	Gauge		D			
No	Size	No	Size		mm	in		

Button bit

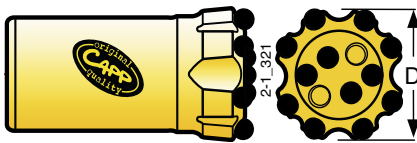

2x11	-	4x10	8x10	30°	64	2 1/2"	HMCVA	7734-2664-S45
------	---	------	------	-----	----	--------	-------	---------------

X-bit

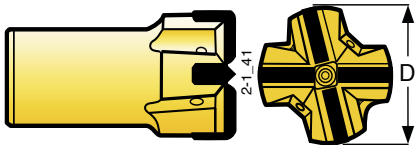

1x7.5	2x7.5	-	-	-	70	2 3/4"	-	7734-4070-11
-------	-------	---	---	---	----	--------	---	--------------

Dimensions

L		D		Part No.
mm	ft	mm	in	

Extension rod, R38 - Round 39 - R38

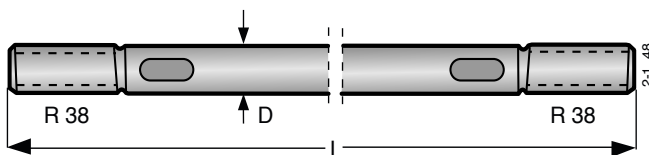

1220	4'	-	39	1 1/2"	7854-4312-30
1830	6'	-	39	1 1/2"	7854-4318-30
2435	8'	-	39	1 1/2"	7854-4324-30
3050	10'	-	39	1 1/2"	7854-4331-30

Flushing hole Ø 14.5 mm. Wrench flat 32 mm.

Coupling sleeve

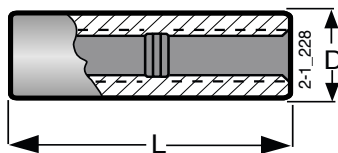

170	-	6 11/16"	55	2 5/32"	7994-3655
-----	---	----------	----	---------	-----------

Bit adapter coupling, R38 - Thread

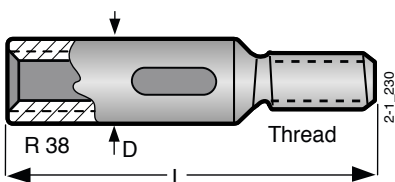

Thread						
R32	270	-	10 41/64"	55	2 5/32"	7834-3303
T38	245	-	9 21/32"	55	2 5/32"	7834-4401

Wrench flat 44.5 mm.

Bench drilling

R38 (1 1/2")

	Dimensions			D		Part No.
	L			mm	in	
	mm	ft	in			

Reduction coupling, R38 - Thread

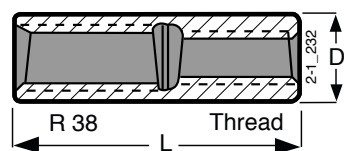

Thread	L			D		Part No.
R32	170	–	6 3/4"	55	2 5/32"	7994-3455
T38	185	–	7 9/32"	55	2 5/32"	7314-4455
T45	220	–	8 21/32"	63	2 31/64"	7315-4463

Shank adapter



See page 87

Bench drilling

T45 (1 3/4")

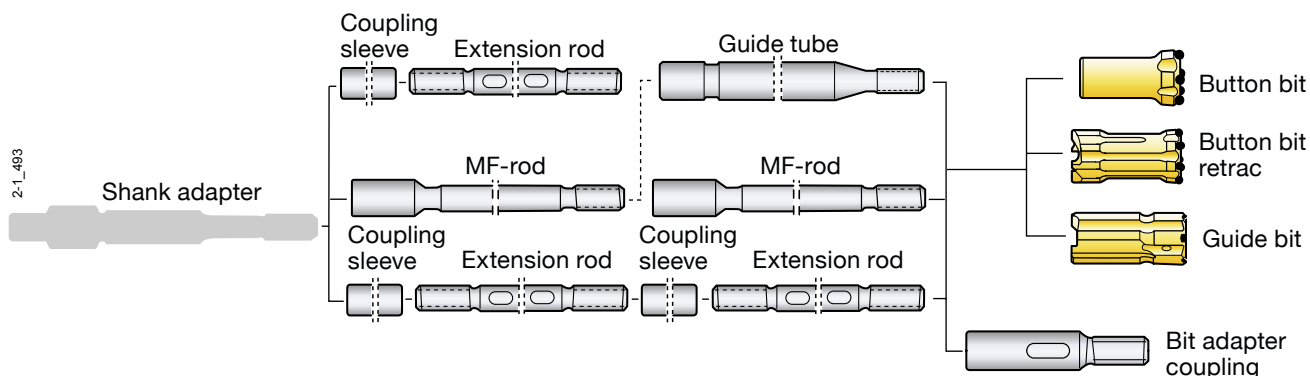

Flushinghole, mm		Buttons, mm			Dimensions		Bit classification	Part No.
Front No	Gauge Size	Front No	Gauge Size	Angle	D mm	in		

Button bit

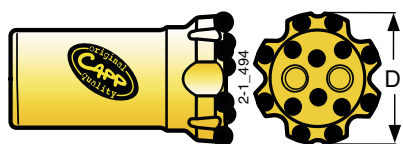

2x12	—	6x10	8x11	35°	76	3"	HMCVA	7515-2676-S45
2x12	—	6x10	8x11	40°	76	3"	MSCAN	7515-2676-R55

Button bit

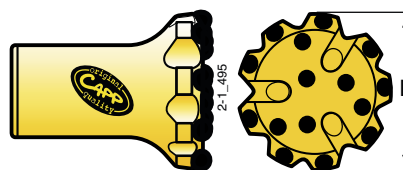

3x10	—	6x10	9x11	40°	89	3 1/2"	MSCAN	7515-2689-R55
3x10	—	6x12	9x12	35°	102	4"	HMCVA	7515-2602-S45

Button bit



3x9	—	4x11	7x12	35°	76	3"	HMCVA	7515-3876-S45
3x9	—	4x11	7x12	35°	76	3"	HMCV	7515-3876-S65

Button bit

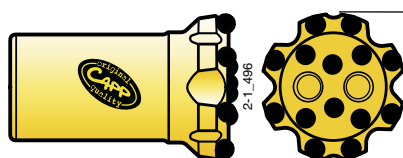

2x13	—	6x13	8x13	35°	89	3 1/2"	HMCVA	7515-3889-S45
2x13	—	6x13	8x13	35°	89	3 1/2"	HMCV	7515-3889-S65

Button bit, Drop Center

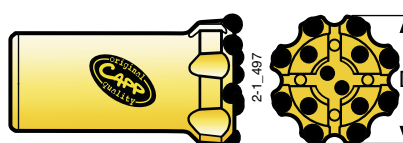

7.0	—	6x10	8x11	30°	76	3"	HMCVA	7515-5976-S45
8.0	—	6x10	8x11	35°	76	3"	MSCAN	7515-5976-R55
8.0	—	6x11	8x12	35°	89	3 1/2"	HMCVA	7515-5989-S45
8.0	—	7x11	8x12	40°	89	3 1/2"	MSCAN	7515-5989-R55
4x9.0	—	7x12	8x13	35°	102	4"	HMCVA	7515-5902-S45

Button bit, Retrac



2x12	—	6x10	8x11	35°	76	3"	HMCVFA	7515-7876-S45
2x12	—	6x10	8x11	40°	76	3"	MSCFAN	7515-7876-R55

Bench drilling

T45 (1 3/4")

Flushinghole, mm		Buttons, mm			Dimensions		Bit classification	Part No.
Front	Gauge	Front	Gauge	Angle	D			
No Size	No Size	No Size	No Size		mm	in		

Button bit, Retrac

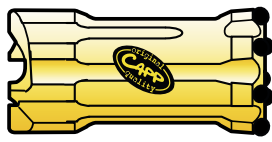
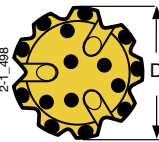
		3x10	—	6x10	9x11	35°	89	3 1/2"	HMCFVA	7515-7889-S45
		3x10	—	6x10	9x11	35°	89	3 1/2"	HMCFV	7515-7889-S65
		3x10	—	6x10	9x11	40°	89	3 1/2"	MSCFAN	7515-7889-R55
		3x10	—	6x12	9x12	35°	102	4"	HMCFVA	7515-7802-S45
		3x10	—	6x12	9x12	40°	102	4"	MSCFAN	7515-7802-R55
		3x10	—	6x12	9x12	35°	102	4"	HMCFV	7515-7802-S65

Button bit, Retrac, Drop Center

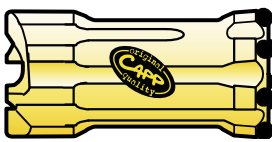
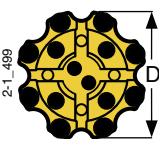
		4x7	—	5x10	8x10	35°	70	2 3/4"	MSCFAN	7515-7970-R55
		4x7	—	6x10	8x11	30°	76	3"	HMCFVA	7515-7976-S45
		4x7	—	6x10	8x11	35°	76	3"	MSCFAN	7515-7976-R55
		4x8	—	6x11	8x12	35°	89	3 1/2"	HMCFVA	7515-7989-S45
		4x8	—	7x11	8x12	40°	89	3 1/2"	MSCFAN	7515-7989-R55
		4x9	—	7x12	8x13	40°	102	4"	MSCFAN	7515-7902-R55
		4x9	—	7x12	8x13	35°	102	4"	HMCFVA	7515-7902-S45

Guide bit

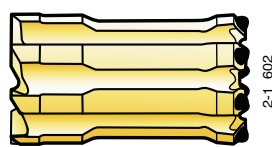
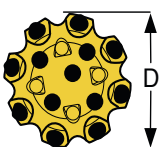
		4x8	—	5x10	8x10	35°	70	2 3/4"	—	7515-8270-R45
		4x8	—	5x10	8x11	35°	76	3"	—	7515-8276-R45
		4x10	—	5x11	8x12	40°	89	3 1/2"	—	7515-8289-R45

X-bit

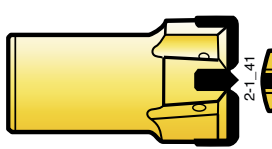
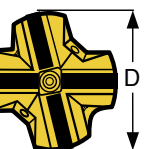
		1x7.5	4x7.5	—	—	—	89	3 1/2"	—	7515-4489-11
--	---	-------	-------	---	---	---	----	--------	---	--------------

Dimensions		Part No.	
L	D		
mm	ft	in	mm

Guide tube

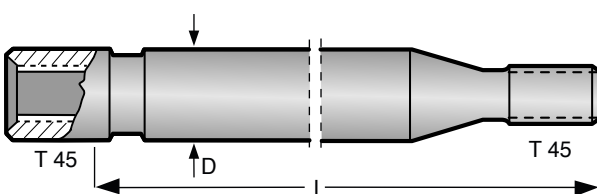
	Bit dia. mm								
	76-89	1830	6'	—	63	2 1/2"	7956-6318-21		
	76-89	3660	12'	—	63	2 1/2"	7956-6337-21		
	89-102	1830	6'	—	76	3"	7956-7618-20		
	89-102	3660	12'	—	76	3"	7956-7637-20		

Female end OD 63 mm / 76 mm.

MF-rod T45 - Round 46 - T45

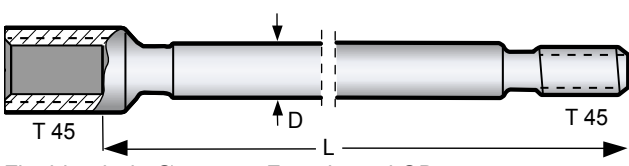
	1525	5'	—	46	1 3/4"	7325-7715C-20
	1830	6'	—	46	1 3/4"	7325-7718C-20
	3050	10'	—	46	1 3/4"	7325-7731-70
	3660	12'	—	46	1 3/4"	7325-7737-70
	4265	14'	—	46	1 3/4"	7325-7743-70
	6095	20'	—	46	1 3/4"	7325-7761-70

Flushing hole Ø 17 mm. Female end OD 63 mm.

Bench drilling

T45 (1 3/4")

	Dimensions			D		Part No.
	L			mm	in	
Extension rod T45 - Round 46 - T45	3050	10'	-	46	1 3/4"	7325-7331C-30
	3660	12'	-	46	1 3/4"	7325-7337C-30
	4265	14'	-	46	1 3/4"	7325-7343C-30
	6095	20'	-	46	1 3/4"	7325-7361C-30

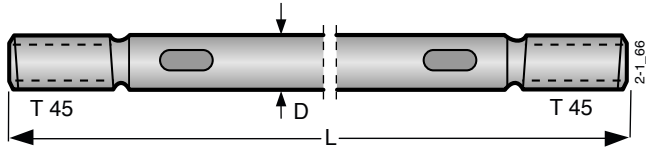

Flushing hole Ø 17 mm. Wrench flat 38 mm.

Light extension rod, T45 - Hex 38 - T45	3050	10'	-	38	1 1/2"	7325-4031-20
---	------	-----	---	----	--------	--------------

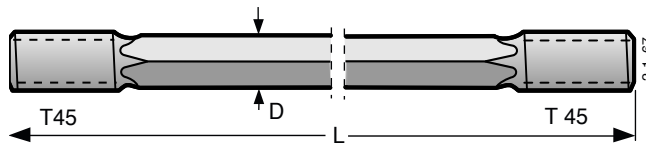

Flushing hole Ø 16 mm.

Coupling sleeve T45	210	-	8 1/8"	63	2 31/64"	7315-3663
---------------------	-----	---	--------	----	----------	-----------

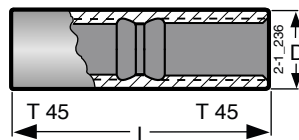

Bit adapter coupling, T45 -Thread	Thread		L		D		Part No.	
	W=38	T38						
	265	-	10 7/16"	63	2 31/64"	7335-4401		
	W=44.5	T51	285	-	11 7/32"	63	2 31/64"	7335-6401

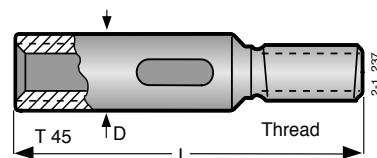

Wrench flat W

Reduction coupling, T45 - Thread	Thread		L		D		Part No.
	T38	T51					
	220	-	8 43/64"	61	2 13/32"	7314-6261	
	218	-	8 19/32"	71	2 51/64"	7316-6271	

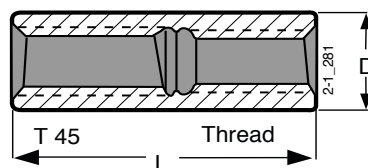

Shank adapter							See page 87
---------------	--	--	--	--	--	--	-------------



Bench drilling

T51 (2")

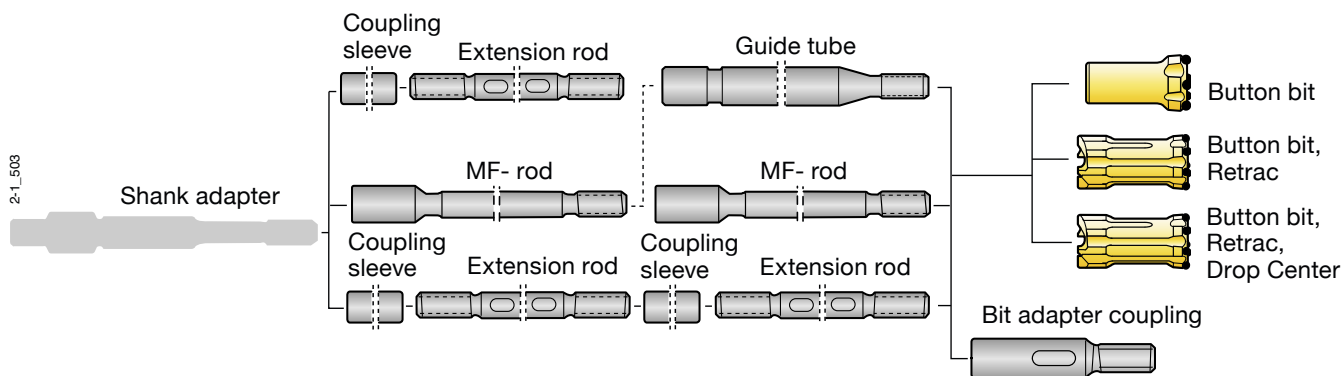

Flushinghole, mm		Buttons, mm			Dimensions		Bit classification	Part No.
Front No	Gauge Size	Front No	Gauge Size	Angle	D mm	in		

Button bit

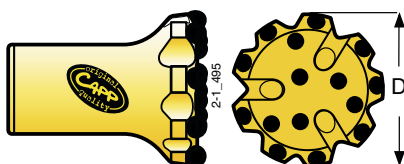

3x12	—	6x10	9x11	35°	89	3 1/2"	HMCVA	7516-2689-S45
3x12	—	6x12	9x12	35°	102	4"	HMCVA	7516-2602-S45
3x12	—	9x12	9x13	35°	115	4 1/2"	HMCVA	7516-2615-S45
3x13	—	9x13	9x14	35°	127	5"	HMCVA	7516-2627-S45

Button bit, Drop Center

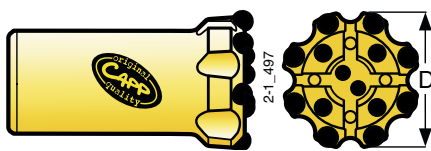

4x10	—	6x11	8x12	35°	89	3 1/2"	HMCVA	7516-5989-S45
4x10	—	7x11	8x12	40°	89	3 1/2"	MSCAN	7516-5989-R55
4x11	—	7x12	8x13	35°	102	4"	HMCVA	7516-5902-S45
4x11	—	7x12	8x13	40°	102	4"	MSCAN	7516-5902-R55
4x10	—	7x13	8x14	35°	115	4 1/2"	HMCVA	7516-5915-S45
4x10	—	7x14	8x14	35°	127	5"	HMCVA	7516-5927-S45

Button bit, Retrac

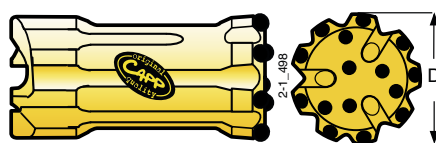

3x12	—	6x10	9x11	35°	89	3 1/2"	HMCFVA	7516-7889-S45
3x12	—	6x10	9x11	40°	89	3 1/2"	MSCFAN	7516-7889-R55
3x12	—	6x12	9x12	35°	102	4"	HMCFVA	7516-7802-S45
3x12	—	9x12	9x13	35°	115	4 1/2"	HMCFVA	7516-7815-S45

Button bit, Retrac, Drop Center



4x10	—	6x11	8x12	35°	89	3 1/2"	HMCFVA	7516-7989-S45
4x10	—	7x11	8x12	40°	89	3 1/2"	MSCFAN	7516-7989-R55
4x11	—	7x12	8x13	35°	102	4"	HMCFVA	7516-7902-S45
4x11	—	7x12	8x13	40°	102	4"	MSCFAN	7516-7902-R55
4x10	—	7x13	8x14	35°	115	4 1/2"	HMCFVA	7516-7915-S45
4x11	—	7x13	8x14	40°	115	4 1/2"	MSCFAN	7516-7915-R55
4x10	—	7x14	8x14	35°	127	5"	HMCFVA	7516-7927-S45

Bench drilling

T51 (2")

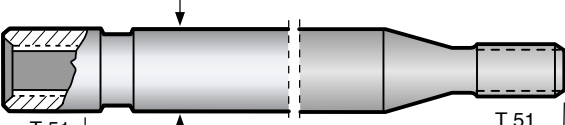
	Dimensions			D		Part No.
	L			mm	in	
	mm	ft	in			
						

Female end OD 76 / 87 mm.

MF-rod, T51 - Round 52 - T51

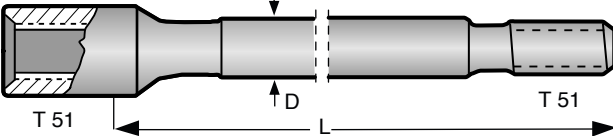
	1830	6'	–	52	2"	7326-5518C-20
	3660	12'	–	52	2"	7326-5537-70
	4265	14'	–	52	2"	7326-5543-70
	6095	20'	–	52	2"	7326-5561-70

Flushing hole Ø 21.5 mm.
Female end OD 71 mm.

Extension rod, T51 - Round 52 - T51

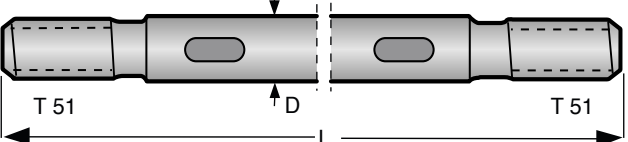
	3660	12'	–	52	2"	7326-5337C-30
	4265	14'	–	52	2"	7326-5343C-30
	6095	20'	–	52	2"	7326-5361C-30

Flushing hole Ø 21.5 mm. Wrench flat 45 mm.

Coupling sleeve, T51

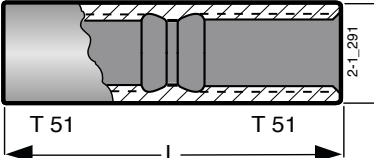
	225	–	8 7/8"	71	2 51/64"	7316-3671
	225	–	8 7/8"	76	3"	7316-3676

Bit adapter coupling, T51 - Thread

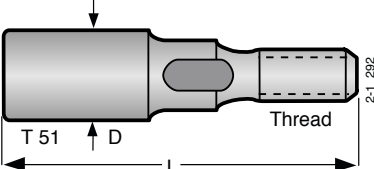
	Thread						
	T45	285	–	11 7/32"	71	2 51/64"	7336-5401
	ST58	–	–	–	–	–	7336-5803

Wrench flat 44.5

Reduction coupling, T51 - Thread

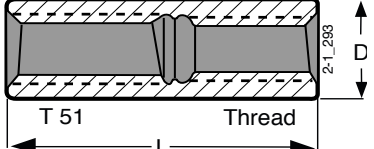
	Thread					
	T45	218	–	8 19/32"	71	2 51/64"

Shank adapter



See page 87

Bench drilling

Sandvik GT60

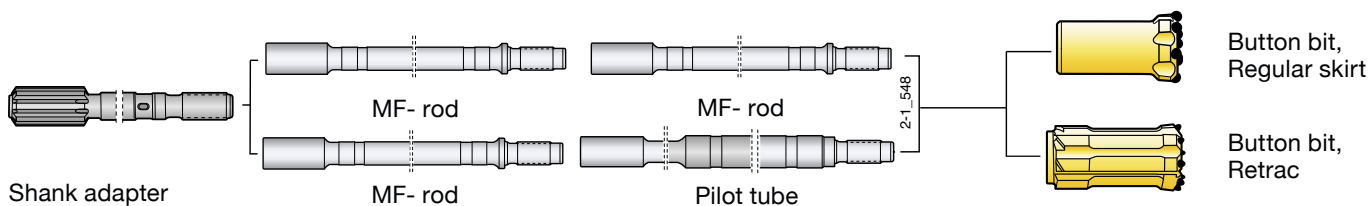

Flushinghole, mm	Front Gauge No Size	Buttons, mm	Front Gauge No Size	Angle	Dimensions		Bit classification	Part No.
					D mm	in		

Button bit, Drop Center

	4x11	—	7x12	8x13	35°	102	4"	MSCVA	7620-5902-S45
	4x11	—	7x13	8x14	35°	115	4 1/2"	MSCVA	7620-5915-S45
	4x11	—	7x14	8x14	35°	127	5"	MSCVA	7620-5927-S55
	4x12	—	4x16+5x13	8x16	35°	140	5 1/2"	MSCVA	7620-5940-S55
	4x12	—	4x16+5x14	8x16	35°	152	6"	MSCVA	7620-5952-S55

Button bit, Flat Face, Heavy Duty

	2x14	—	6x12	8x14	35°	92	3 5/8"	HMCVA	7620-3892-S45
	3x12	—	6x12	9x14	35°	102	4"	HMCVA	7620-3802-S45
	3x13	—	6x13	9x14	35°	115	4 1/2"	HMCVA	7620-3815-S45
	3x13	—	6x14	9x16	35°	127	5"	HMCVA	7620-3827-S55

Button bit, Retrac with ballistic buttons

	2x15	—	6x12	8x13	40°	92	3 5/8"	MSCFAN	7620-7892-R55
	2x13	—	9x11	9x11	40°	92	3 5/8"	MSCFAN	7620-8892-R55

Button bit, Retrac, Drop Center



	4x11	—	7x12	8x13	35°	102	4"	MSCFVA	7620-7902-S45
	4x11	—	7x13	8x14	35°	115	4 1/2"	MSCFVA	7620-7915-S45
	4x11	—	7x14	8x14	35°	127	5"	MSCFVA	7620-7927-S55
	4x12	—	4x16+5x13	8x16	35°	140	5 1/2"	MSCFVA	7620-7940-S55

Button bit, Retrac, Drop Center with ballistic buttons

	3x12	—	4x13	6x14	40°	92	3 5/8"	MSCVA	7620-4792-R55
	4x11	—	7x12	8x13	40°	102	4"	MSCVA	7620-7902-R55
	4x11	—	7x13	8x14	40°	115	4 1/2"	MSCVA	7620-7915-R55

Bench drilling

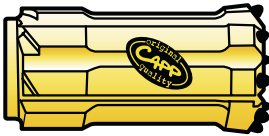
Sandvik GT60

	Flushinghole, mm		Buttons, mm			Dimensions		Bit classification	Part No.		
	Front	Gauge	Front	Gauge	Angle	D					
	No Size	No Size	No Size	No Size		mm	in				
Button bit, Retrac, Flat Face											
			3x12	—	9x11	9x13	35°	102	4"	MSCFVA	7620-4902-S45
			3x12	—	10x12	9x14	35°	115	4 1/2"	MSCFVA	7620-4915-S45
			3x13	—	10x13	9x14	35°	127	5"	MSCFVA	7620-4927-S55
			3x14	—	10x14	9x16	35°	140	5 1/2"	HMCFVA	7620-4940-S55
			3x14	—	12x14	9x16	35°	152	6"	HMCFVA	7620-4952-S55
			3x13	—	6x13	9x16	35°	118	4 5/8"	HMCFVA	7620-8118-S55

	Dimensions			D	Part No.
	L				
	mm	ft	in	mm	in

MF-rod, GT60 - Round 60 - GT60. For bits from 96 mm.

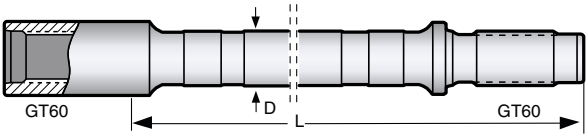
	3660	12'	-	60	2 3/8"	7610-1137-70
	4265	14'	-	60	2 3/8"	7610-1143-70
	6095	20'	-	60	2 3/8"	7610-1161-70
	4265	14'	-	64	2 1/2"	7610-1243-20

Flushing hole Ø 22.5 mm. Female end OD 85 mm.

MF-rod, GT60 - Round 60 - GT60. For 92-115 mm bits.

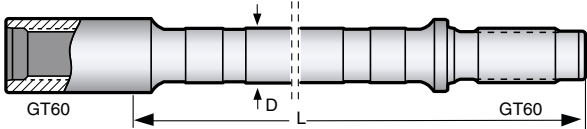
	3660	12'	-	60	2 3/8"	7610-1437-70
	4265	14'	-	60	2 3/8"	7610-1443-70

Flushing hole Ø 22.5 mm. Female end OD 82 mm.

Pilot Tube

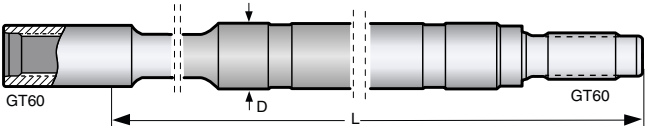
	1600	5' 3"	—	87	3 1/2"	7640-8716-70
	4265	14'	—	87	3 1/2"	7640-8743-70
	5335	17' 6"	—	76	3"	7640-7653-70

Female end OD 85 mm (82 mm on 76 mm tubes)

Shank adapter



See page 87