

Sandvik overburden drilling system

For Top Hammer applications

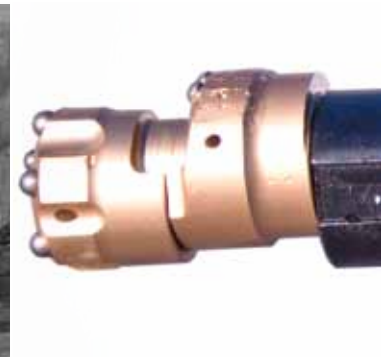

Overburden drilling systems

	Page
Overburden drilling tools, OD72	3
Overburden drilling tools, OD92	5
Eccentric drilling tools, Tubex 76	7
Eccentric drilling tools, Tubex XL90	10

Overburden drilling systems

OD 72 (3 1/2")

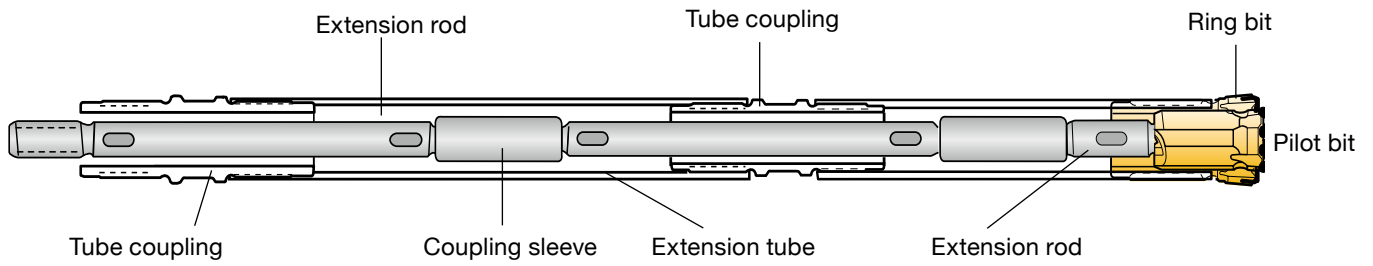

	Flushinghole, mm		Buttons, mm		Angle	Dimensions D		Part No.
	Front No Size	Gauge No Size	Front No Size	Gauge No Size		mm	in	
Pilot bit, R38, button bit	2x11	2x6	4x10	8x10	35°	70	2 3/4"	7734-7870A2-R55

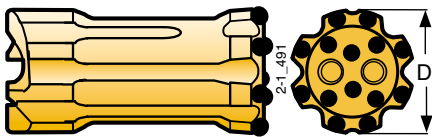

Pilot bit, R38, x-bit	1x6	4x7.5	-	-	-	70	2 3/4"	7734-4070-11
------------------------------	-----	-------	---	---	---	----	--------	---------------------

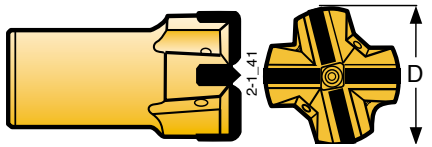

! Non standard product.

Ring bit, C89	5x10	10x10	35°	110	4 21/64"	7588-9510-R55
----------------------	------	-------	-----	-----	----------	----------------------

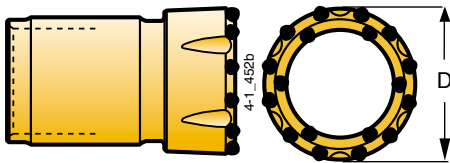

	Dimensions D					Part No.
	L		D			
	mm	ft	in	mm	in	
Extension tube	1120	3'	8 1/8"	103	4 1/16"	7985-6012
	2950	9'	8 1/8"	103	4 1/16"	7985-6031

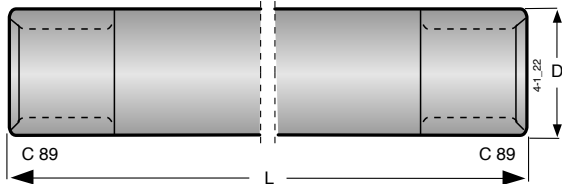

Tube coupling	100	-	3 15/16"	103	4 1/16"	7989-6003
----------------------	-----	---	----------	-----	---------	------------------

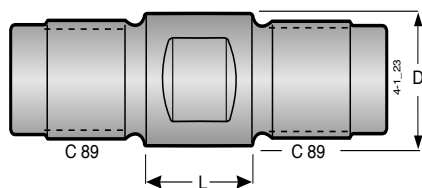

Wrench flat 90 mm.

Overburden drilling systems

OD 72 (3 1/2")

	Dimensions D					Part No.
	L mm	ft	in	D mm	in	
Extension, R38 - Round 39 - R38	280	-	11 1/32"	39	1 1/2"	7854-4302-20

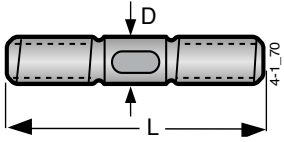

Extension rod, R38 - Round 39 - R38						
1220	4'	-	39	1 1/2"	7854-4312-30	
3050	10'	-	39	1 1/2"	7854-4331-30	

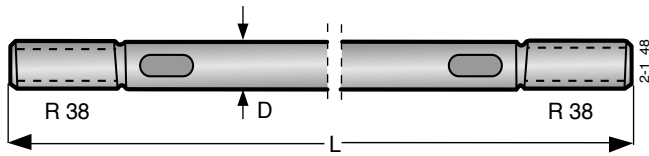

Wrench flat 32 mm.

Coupling sleeve, R38						
170	-	6 11/16"	55	2 5/32"	7994-3655	

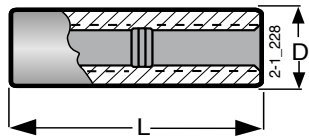

Wrench for extension rod						
370	1'	2 9/16"	32	1 1/4"	795-1432	

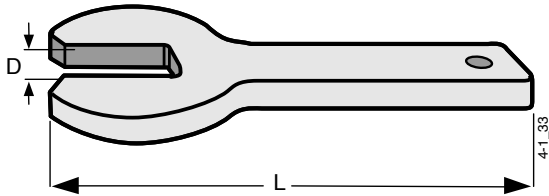

Overburden drilling systems

OD 92 (4 3/8")

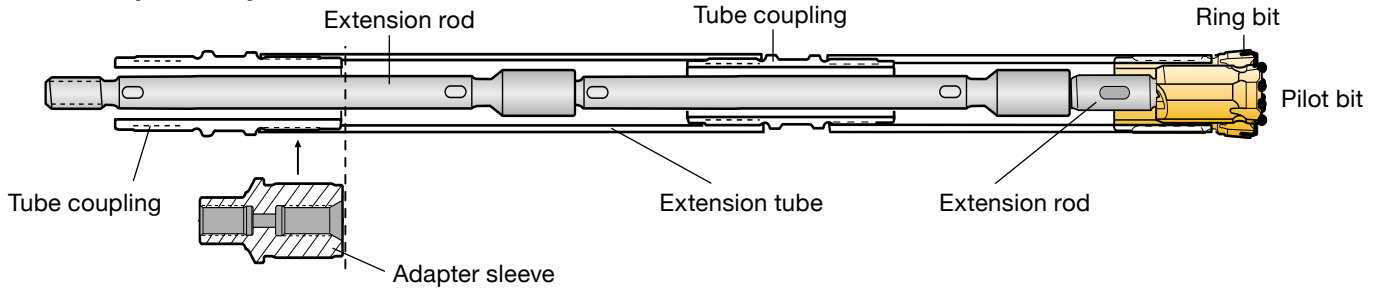

	Flushinghole, mm		Buttons, mm		Angle	Dimensions D		Part No.
	Front No Size	Gauge No Size	Front No Size	Gauge No Size		mm	in	

Pilot bit, T45, button bit

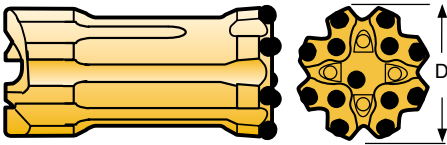

3x10	–	5x10	9x11	35°	89	3 1/2"	7515-4889-R48
------	---	------	------	-----	----	--------	---------------

Pilot bit, T45, x-bit

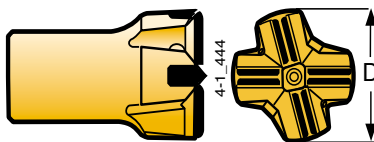

1 7.5	2 7.5	–	–	–	89	3 1/2"	7515-4489-11
-------	-------	---	---	---	----	--------	--------------

! Non standard product.

Ring bit, C110

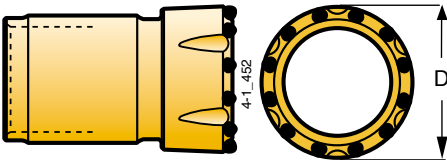

12x12	35°	131	5 5/32"	7588-9531-R55
-------	-----	-----	---------	---------------

Extension tube

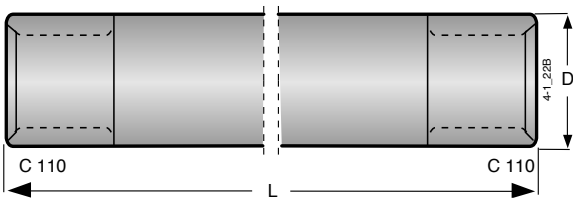

	Dimensions D				Part No.
	L mm	ft	in	D mm	
1100	3'	7 5/16"	124	4 7/8"	7985-6112
2930	9'	7 23/64"	124	4 7/8"	7985-6131

Tube coupling

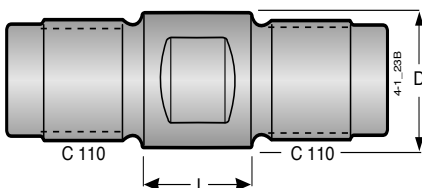

120	–	4 47/64"	124	4 7/8"	7989-6103
120	–	4 47/64"	124	4 7/8"	7989-6503 1)

Wrench flat 110 mm. 1) With cutting outlet.

Overburden drilling systems

OD 92 (4 3/8")

	Dimensions D					Part No.
	L mm	ft	in	D mm	in	

Extension, T45 - Round 46 - T45

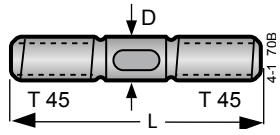

Thread T45	280	-	11 1/32"	46	1 3/4"	7325-7302-21 !
------------	-----	---	----------	----	--------	-----------------------

! Non standard product.

MF-rod T45 - Round 46 - T45

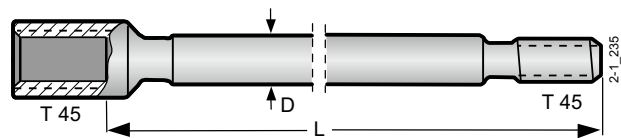

3050	10'	-	46	1 3/4"	7325-7731E-28 !
------	-----	---	----	--------	------------------------

! Non standard product.

Flushing hole 18 Ø mm. Female end OD 71 mm. Two wrench flats.

Adapter sleeve, T45 - C110 / T45

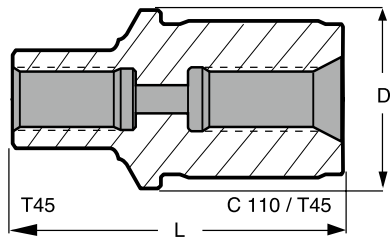

235	-	-	124	-	7989-6751
-----	---	---	-----	---	------------------

Wrench for extension rod

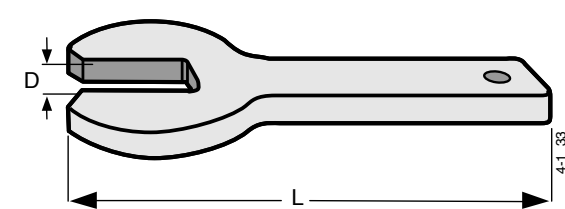

370	1'	2 9/16"	38	1 1/2"	795-1494
-----	----	---------	----	--------	-----------------

Overburden drilling systems

TUBEX 76 eccentric drilling tools for top hammers

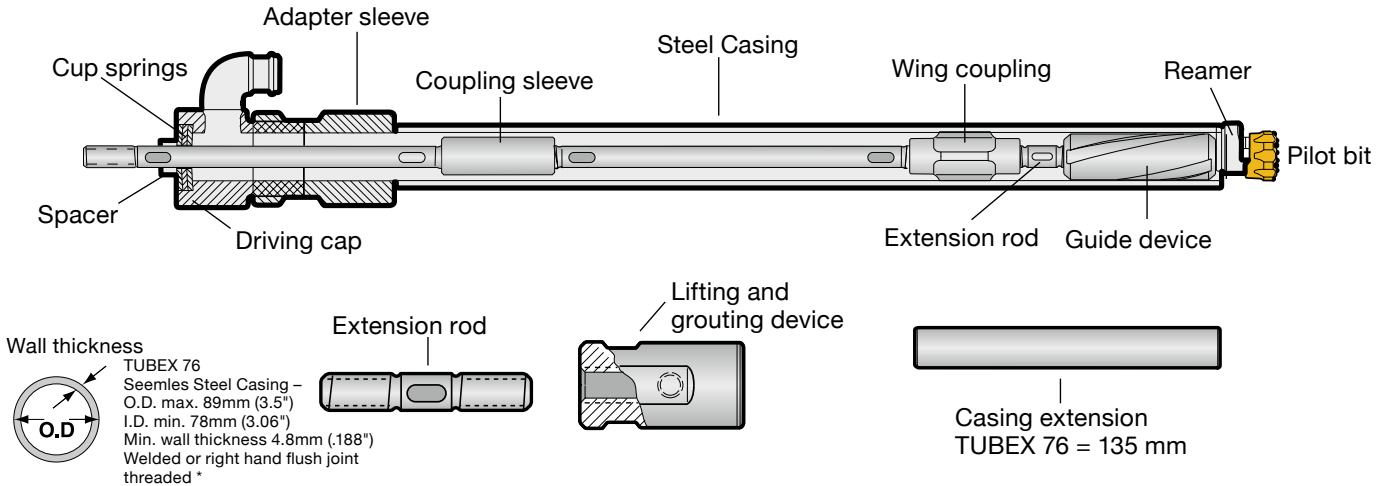

	Flushinghole, mm		Buttons, mm		Angle	Dimensions D		Part No.
	Front No Size	Gauge No Size	Front No Size	Gauge No Size		mm	in	
Pilot bit								
	1x6	2x6	5x10	6x12	35°	70	2 3/4"	7588-0570-40

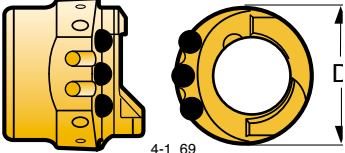
Eccentric reamer button bit DP 60								
	-	2x5	-	3x10	30°	77	3 1/32"	7588-0596-60
	Reaming Dia.					96	3 25/32"	

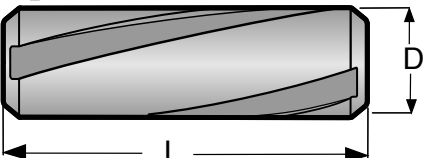
	Thread	L	Dimensions D				Part No.
			mm	ft	in	D mm	
Guide device							
	Thread R38	270	-	10 5/8"	76	3"	7989-1577

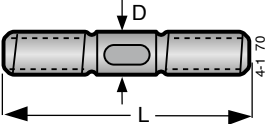
Tube coupling							
	Thread R38 - R38	280	-	11"	39	1 1/2"	7854-4302-20

* Welded and threaded casing to be bought locally.

Overburden drilling systems

TUBEX 76 eccentric drilling tools for top hammers

	Thread	Tubex	Dimensions D					Part No.
			L mm	ft	in	D mm	in	

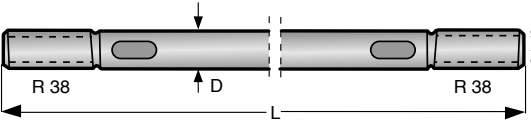
Extension, R38 - Round 39 - R38								
	R38 - R38	76	1220	4'	-	39	1 1/2"	7854-4312-30
	R38 - R38	76	1830	6'	-	39	1 1/2"	7854-4318-30
	R38 - R38	76	2435	8'	-	39	1 1/2"	7854-4324-30
	R38 - R38	76	3000	-	-	39	1 1/2"	7854-4331-33
	R38 - R38	76	3050	10'	-	39	1 1/2"	7854-4331-30

! Non standard product.

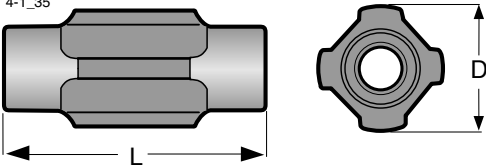
Wing coupling								
	R38 - R38	76	180	-	7 1/16"	76	3"	7994-3076

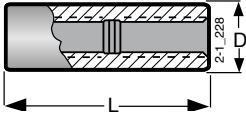
Coupling sleeve								
	R38 - R38	76	170	-	6 11/16"	55	2 5/32"	7994-3655

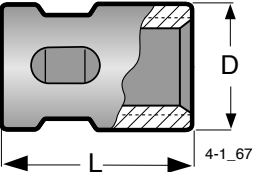
Adapter sleeve for threaded equipment								
	-	76	200	-	7 7/8"	118	4 41/64"	7989-1508

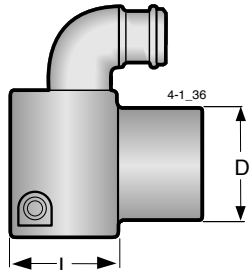
Driving cap, hose connection 63.5 (2 1/2")								
	-	76	138	-	5 1/2"	94	3 45/64"	7989-1544

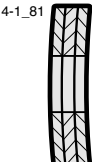
Cup spring (3 pcs required) 80x40x5								
	-	76	-	-	-	-	-	795-2010

Overburden drilling systems

TUBEX 76 eccentric drilling tools for top hammers

	Thread	Tubex	Dimensions D					Part No.
			L mm	ft	in	D mm	in	
Spacer								
	–	76/127	62	–	2 7/16"	81	3 3/16"	7989-1505

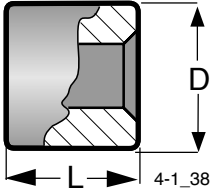

Lifting and grouting device

–	76	210	–	8 17/64"	108	4 1/4"	7989-1509
---	----	-----	---	----------	-----	--------	------------------

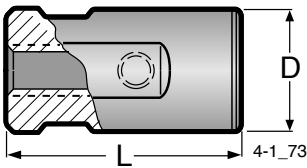

Extension rod for lifting- and grouting device

–	76	280	–	11"	39	1 1/2"	7854-4302-20
---	----	-----	---	-----	----	--------	---------------------

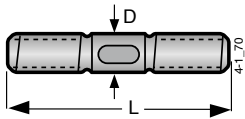

Driving sleeve for shank adapters with male thread R38

R38 – R38		199	–	7 27/32"	83	3 17/64"	7989-1512
-----------	--	-----	---	----------	----	----------	------------------

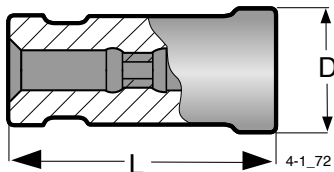

Wrench flat 65 mm.

Overburden drilling systems

TUBEX XL90 eccentric drilling tools for top hammers. With casing shoe

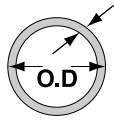

Tubex XL 90
Seamless Steel Casing –
O.D. max. 115 mm (4.5")
I.D. min. 102 mm (4")
Min. wall thickness 6.4mm (.25")
Welded or right hand flush joint threaded*

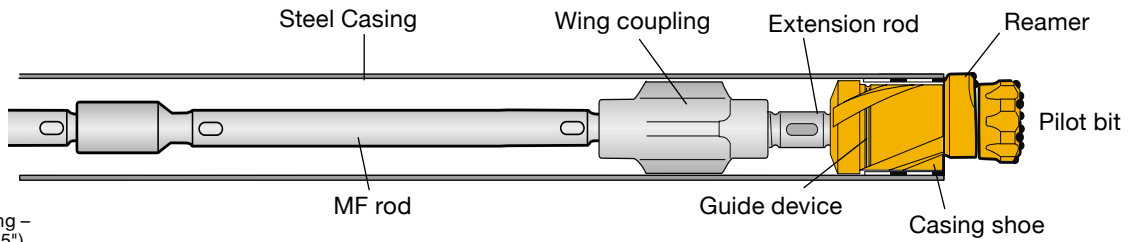

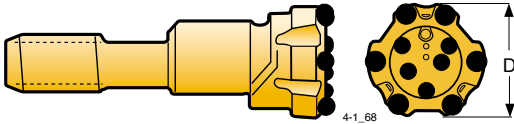
Pilot bit	Flushinghole, mm		Buttons, mm		Angle	Dimensions D		Part No.
	Front No Size	Gauge No Size	Front No Size	Gauge No Size		mm	in	
	1x12	3x8	6x12	8x12	35°	90	3 35/64"	81-090L-090A60

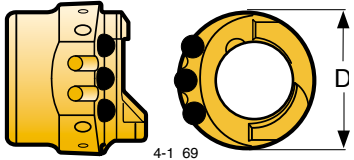
Eccentric reamer	Flushinghole, mm		Buttons, mm	Angle	Angle	Dimensions D		Part No.
	Front No Size	Gauge No Size	Front No Size			mm	in	
	–	–	–	3x12	35°	90	3 35/64"	82-090L-123A60
Reaming Dia.						123	4 27/32"	

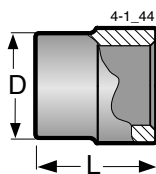
Casing shoe	Thread	Tubex	Dimensions D				Part No.	
			L mm	ft	in	D mm		in
	–	XL90	80	–	3 1/8"	101	3 31/32"	84-090D-00

Guide device	Thread	Tubex	L mm	ft	in	D mm	in	Part No.

Extension rod	Thread	Tubex	L mm	ft	in	D mm	in	Part No.

* Welded and threaded casing to be bought locally.

Overburden drilling systems

TUBEX XL90 eccentric drilling tools for top hammers. With casing shoe

	Thread	Tubex	Dimensions D					Part No.
			L mm	ft	in	D mm	in	

Wing coupling

4-1_35	T45 – T51	XL90	215	–	8 15/32"	100	4 21/64"	7316-6200
--------	-----------	------	-----	---	----------	-----	----------	-----------

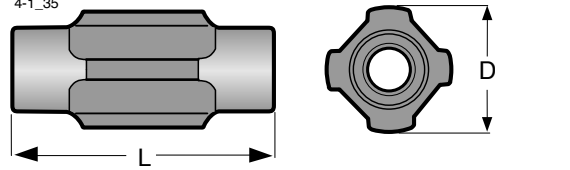

MF-rod T45 - Round 46 - T45

T45 – T45	–	3050	10'	–	46	1 3/4"	7325-7731E-28	!
-----------	---	------	-----	---	----	--------	---------------	---

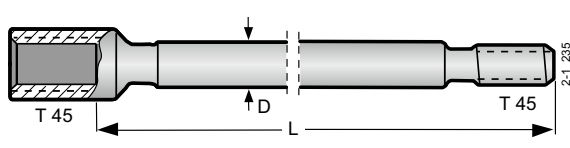

Flushing hole 18 Ø mm. Female end OD 71 mm. Two wrench flats.

! Non standard product.

Locking kit

								85-090A-KT
---	--	--	--	--	--	--	--	------------



www.sandvik.com

SANDVIK MINING AND CONSTRUCTION TOOLS AB SE-811 81 SANDVIKEN, SWEDEN. PHONE: +46 26 26 20 00 FAX: +46 26 26 23 00